

This map is reproduced from Ordnance Survey material with the permission of Ordnance Survey on behalf of the Controller of Her Majesty's Stationery Office. © Crown copyright. Unauthorised reproduction infringes Crown copyright and may lead to prosecution or civil proceedings. Stockton-on-Tees Borough Council 100023297 2010

This drawing should not be scaled. All dimensions must be checked on site and contractor to report any omissions or errors to the contract administrator

NOTES

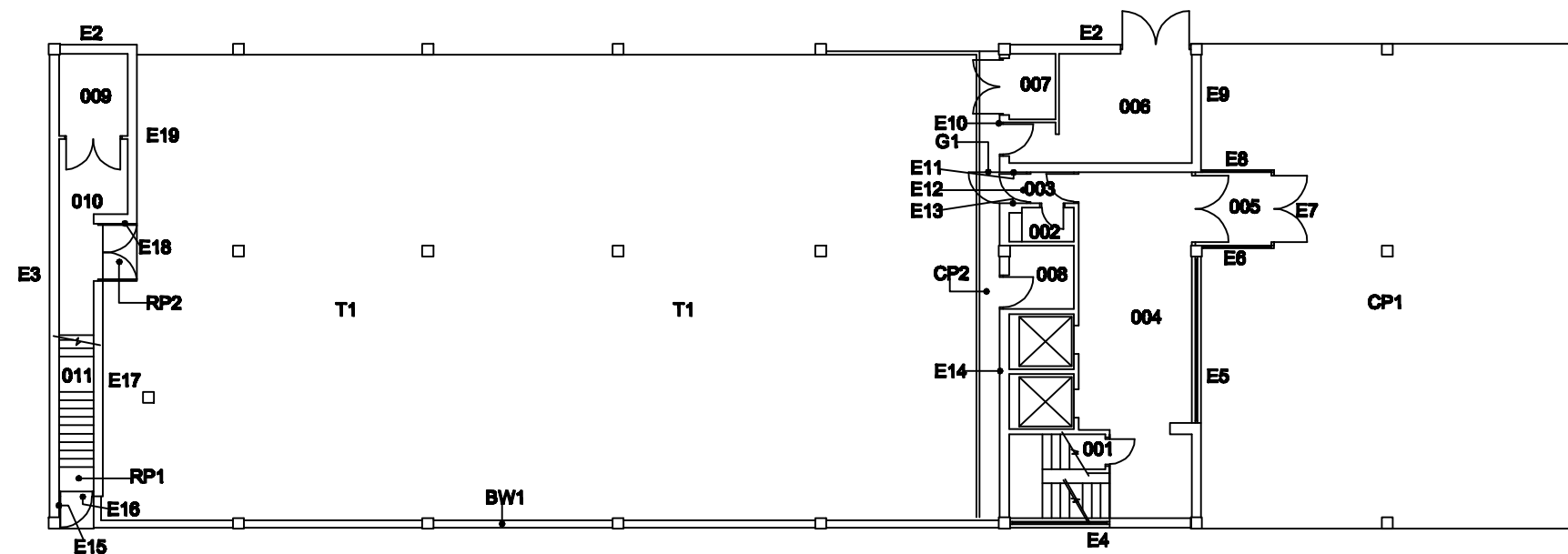

Ground Floor Plan

Rev	Description	Dm	Chk	Date
Drawing Status: PRELIMINARY <input type="checkbox"/> APPROVAL <input type="checkbox"/> INFORMATION <input type="checkbox"/> TENDER <input type="checkbox"/> CONSTRUCTION <input type="checkbox"/>				
 <b>Stockton-on-Tees</b> BOROUGH COUNCIL <i>Passionate about Stockton-on-Tees</i>				
<b>Development &amp; Neighbourhood Services</b> Head of Technical Services Richard McGuckin B.Eng., C.Eng., M.I.C.E. P.O.Box 229, Kingway House, West Precinct, Billingham, TS23 2YL. Telephone (01642) 393939. E-mail: technicalservices@stockton.gov.uk				
<b>Project</b> Bayheath House Prince Regent Street Stockton				
<b>Content</b> Ground Floor Plan				
<b>Date</b> March 02		<b>Dwg No.</b> 10009307498_01FP		
<b>Drawn</b> AE	<b>Checked</b>	<b>Scale @ A3</b> 1:200		<b>Rev</b>