

For identification purposes

**TO LET**



# OPEN STORAGE LAND

Durham Way North, Newton Aycliffe Industrial Estate DL5 6EP

Approximately 0.28 Ha (0.70 Acres)

CONNECT NORTH EAST  
PROPERTY  
01642 602001

## LOCATION

The property is located on the heart of Aycliffe Industrial Estate one of the largest estates in the North East., which provides excellent access to the A167 and Junction 59 of the A1(M).

County Durham has a population of 521,400 with an economically active workforce of 260,600, with 18.4% employed in manufacturing and storage & transportation

The site sits prominent to St Cuthbert's Way/ Durham Way North in close proximity to its junction with the A167.

Surrounding occupiers include:

- Greggs
- Gestamp
- Crafter Companion
- Linde
- PWS

## DESCRIPTION

The property incorporates the following specification:

- Electricity
- Water/ Drainage
- Securely Fenced and Gated
- Stoned Hardstanding
- Prominent location

## ACCOMMODATION

The total site area is approximately 0.28 HA (0.70 Acres)

## TERMS

The property is available To Let by way of a new full repairing and insuring lease. Further information is available upon application.

The site is available in whole or part.

## RATING ASSESSMENT

We understand the property will be assessed for business rates upon occupation

## ENERGY PERFORMANCE CERTIFICATE

N/A

## SERVICE CHARGE

N/A

## VIEWING

Strictly through the joint agents Connect Property North East:

**Jonathan Simpson** ddl: 01642 704931

**Email:** [jonathan@cpne.co.uk](mailto:jonathan@cpne.co.uk)

Or Savills

**Richard Scott** ddl: 0191 3233147

**Email:** [richard.scott@savills.com](mailto:richard.scott@savills.com)

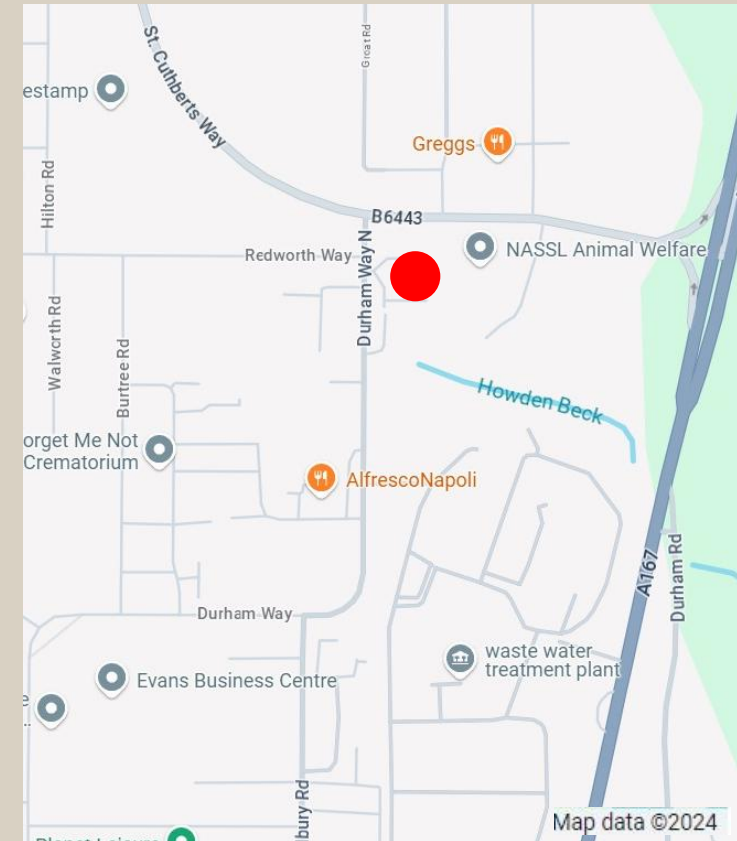

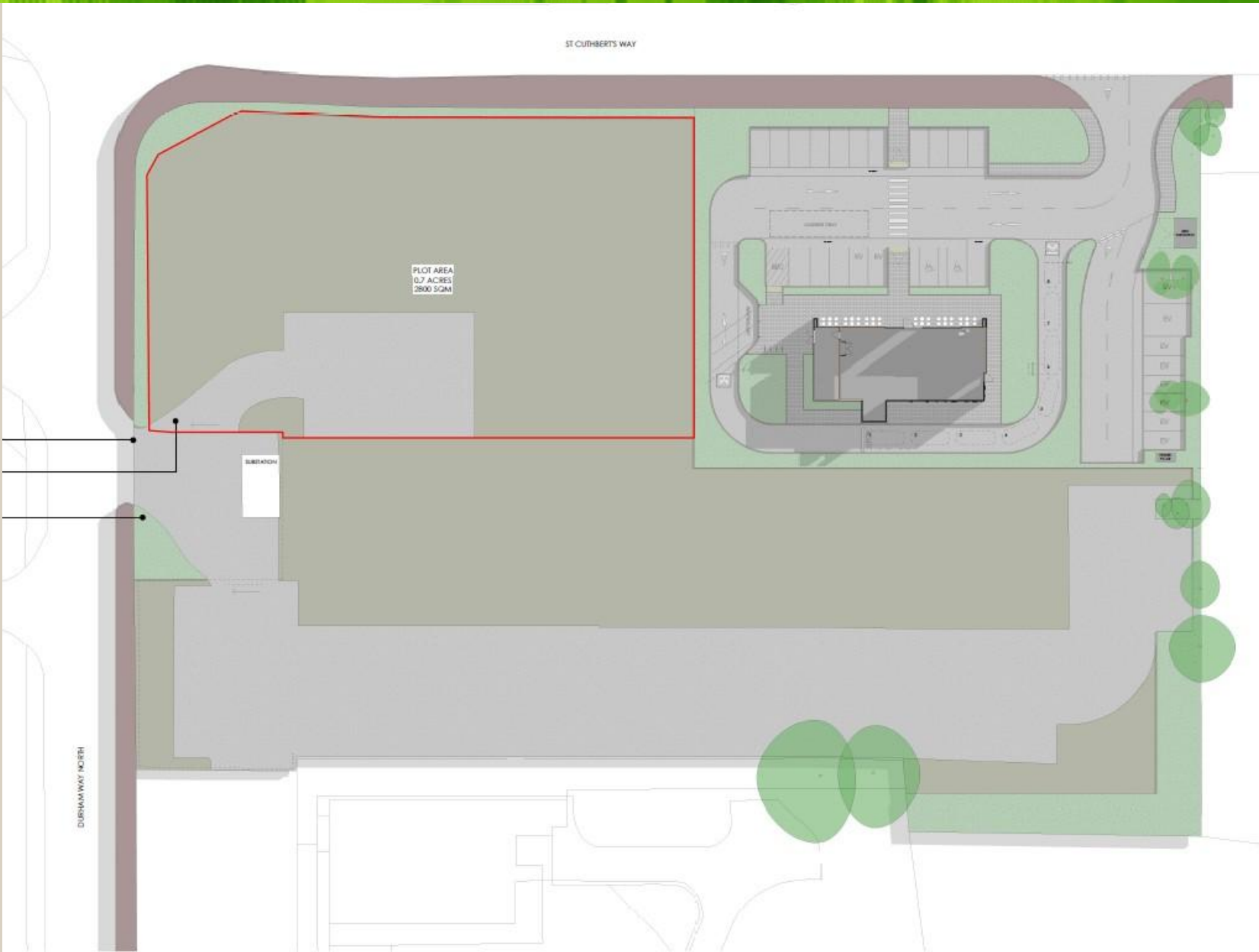

**IMPORTANT NOTICE:** whilst every reasonable effort has been made by Connect Property North East to ensure accuracy, interested parties are strongly advised to take appropriate steps to verify by independent inspection or enquiry all information for themselves and to take appropriate professional advice. (i) No description or information given about the property or its value, whether written or verbal or whether or not in these particulars ('information') may be relied upon as a statement of representation or fact. Connect Property North East nor its employees have any authority to make any representation and accordingly ny information given is entirely without responsibility on the part of Connect Property North East or the seller / lessor. (ii) Any photographs show only certain parts of the property at the time they were taken. Any areas, measurements or distances given are approximate only. (iii) Any reference to alterations to, or use of any part of the property is not a statement that any necessary planning, building regulations or other consent has been obtained. These matters must be verified by any intending buyer / lessee. (iv) Any buyer/lessee must satisfy himself by inspection or otherwise as to the correctness of any information given. (v) VAT is applicable unless expressly stated otherwise. Registered Company Number 9404628